

SG 8600

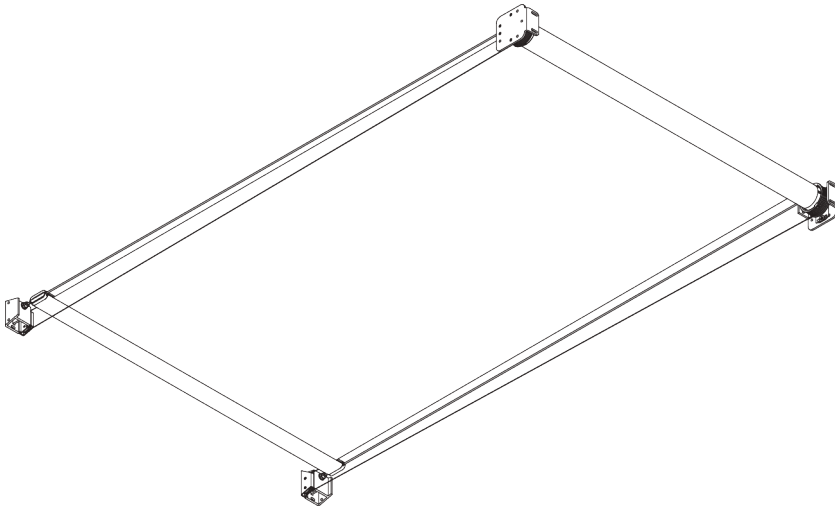

PRODUCT INFORMATION

- **Operation:** motorised
- **Range:** M - L
- **Fitting:** ceiling, wall
- **Colours:** white RAL 9016, special colours possible
- **Fabrics:** refer to Silent Gliss fabric collection

Features:

- Tensioned roller blind
- Various control options
- Any angle

SYSTEM SPECIFICATIONS

A. SYSTEM DIMENSIONS

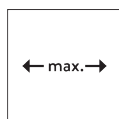

4 m

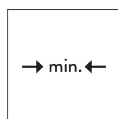

M: 87 cm
L: 108 cm

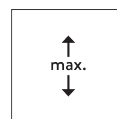

M: 3 m
L: 6.5 m

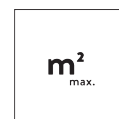

18 m²

B. PROFILE

Profile information

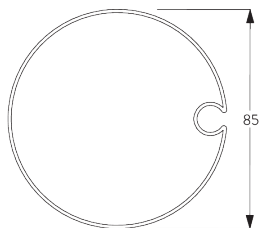

SG 8601

Tube ø 85 mm

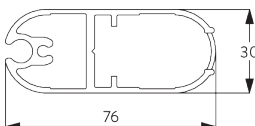

SG 8602

Bottom bar

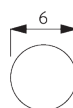

SG 8618

Fabric rod ø 6 mm

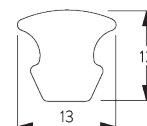

SG 8626

Cover strip

C. HOW TO MEASURE

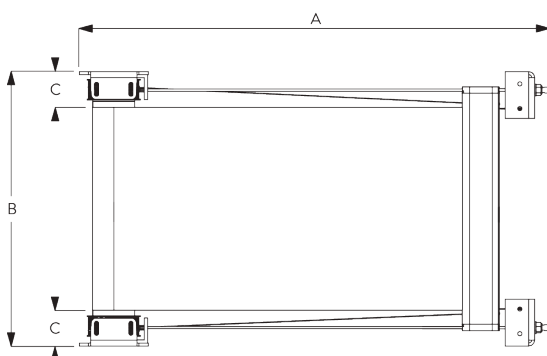

A: System length

B: System width

C: Light gap: 75 mm

Pulling force per bracket: approx. 100 kg

FITTING

A. FITTING INFORMATION

For detailed fitting information, visit the Silent Gliss website.

B. CEILING FITTING

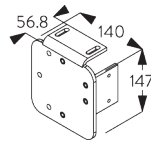
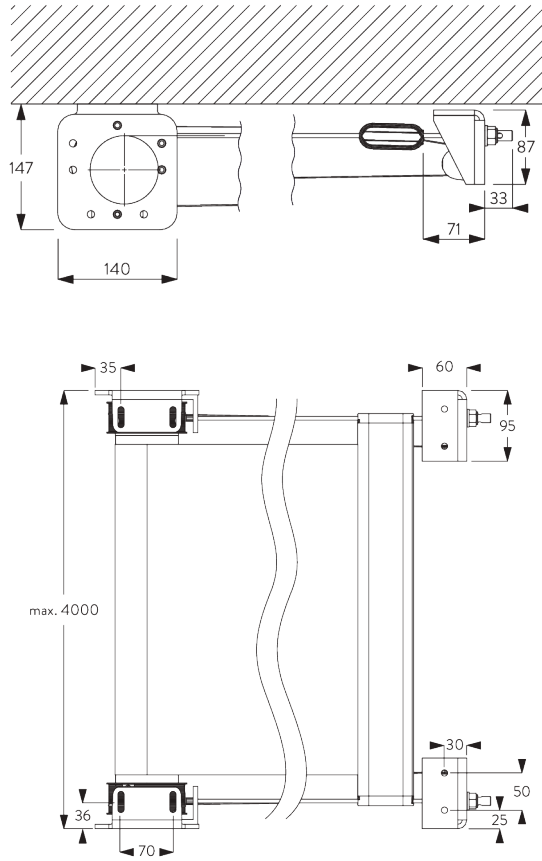

SG 8606
Roller bracket ceiling left

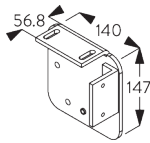

SG 8607
Roller bracket ceiling right

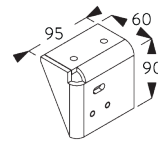

SG 8608
Pulley bracket ceiling left

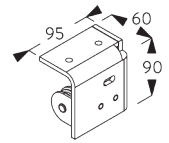

SG 8609
Pulley bracket ceiling right

C. WALL FITTING

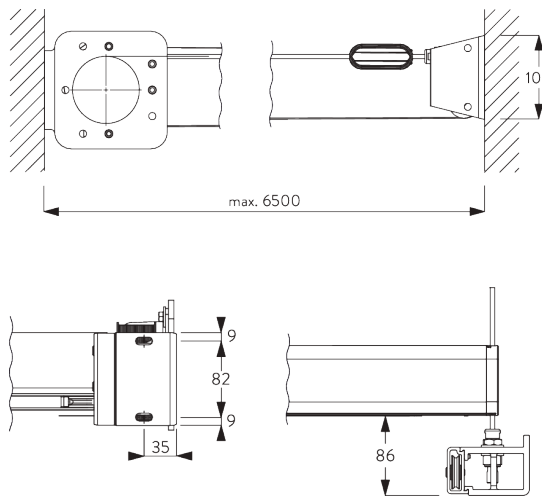

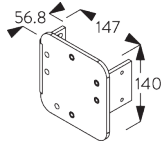

SG 8611
Roller bracket wall left

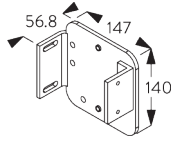

SG 8612
Roller bracket wall right

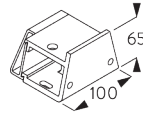

SG 8621
Pulley bracket side/back left

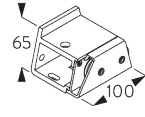

SG 8622
Pulley bracket side/back right

MOTORS & CONTROLS

A. MOTOR FEATURES

Motors	SG 8605
Motor Features	
Mechanical end-stop	●
Mechanical revolution counter (limited revolution)	●
IP class	IP 44
Control Features	
Mains power control	●
SG Control L (external receiver required)	●
Suitable for most major home automation systems (with suitable interface)	●

B. MOTOR SPECIFICATIONS

Motors	Voltage	Current	Frequency	Speed
SG 8605	230 V AC	0.65 A	50 Hz	17 rpm

See website for wiring diagram.

C. OPERATING METHODS

See catalogue "controls" for details.

Wall Switch



System can be operated by fixed wall switch.

SG Control L



Various radio hand-held and wall transmitters available. An external receiver is required.



Silent Gliss Move App.

D. WIRING
DIAGRAMS



Refer to Silent Gliss website.

PARTS

A. STANDARD PARTS



SG 8601

Tube ø 85 mm



SG 8602

Bottom bar

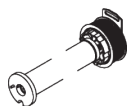

SG 8604

Spring long

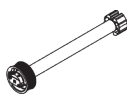

SG 8605

Motor 230V AC, 17/15

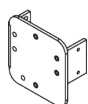

SG 8611

Roller bracket wall left

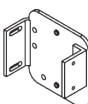

SG 8612

Roller bracket wall right

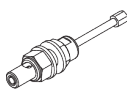

SG 8616

Wire guide set



SG 8618

Fabric rod ø 6 mm

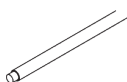

SG 8619

Tension wire ø 1.5 mm

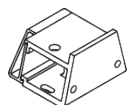

SG 8621

Pulley bracket side/back left

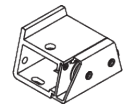

SG 8622

Pulley bracket side/back right

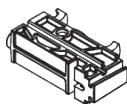

SG 8623

Bottom bar pulley



SG 8624

End cover

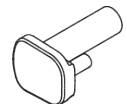

SG 8625

Fabric spacer



SG 8626

Cover strip



SG 9916

Hirschmann plug set

B. OPTIONAL PARTS

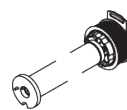

SG 8603

Spring short



SG 8606

Roller bracket ceiling left

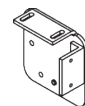

SG 8607

Roller bracket ceiling right



SG 8608

Pulley bracket ceiling left

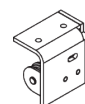

SG 8609

Pulley bracket ceiling right

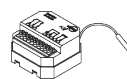

SG 9068

Radio receiver Revio

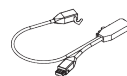

SG 9944

Radio receiver 1 channel



SG 9945

Radio receiver 1 channel

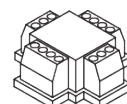

SG 9959

Central control unit relay



SG 10300

Radio hand held 1 channel



SG 10302

Radio hand held 5+1 channel

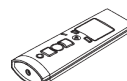

SG 10303

Radio hand held 10+2+1 channel

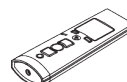

SG 10804

Radio hand held 15+5+1 channel



SG 11480

Radio wall transmitter 1 channel



SG 11490

Radio wall transmitter 5+1 channel
